

C-131-146-140

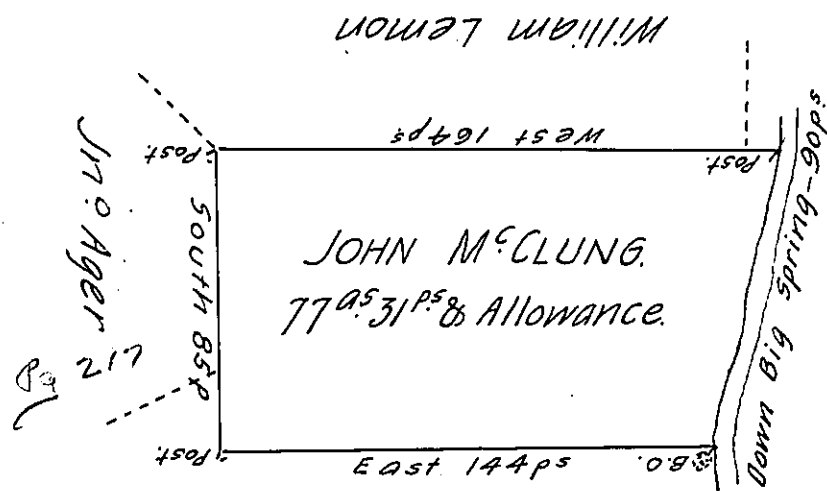

C-142-15-4

Caleb Thomas
C-222-273

A Draught of a Tract of Land situate in Newtown Township, in the County of Cumberland. Containing Seventy Seven Acres and thirty one Perches and a proportional Allowance of Six $\frac{1}{2}$ Cent. for Roads &c. Survey'd October 13th 1767, for John McClung in pursuance of an Order of Survey bearing Date the 16th January 1767, N^o 2439.

John Armstrong

D.S.

To John Lukens, Esqr. }
Surveyor General. }

IN TESTIMONY that the above is a copy of the original remaining on file in the Department of Internal Affairs of Pennsylvania, made conformably to an Act of Assembly approved the 16th day of February, 1833, I have hereunto set my Hand and caused the Seal of said Department to be affixed at Harrisburg, this seventeenth day of April 1906.

Geo. R. Brown
Secretary of Internal Affairs.